



Cylinder Wires



The Indian Card Clothing Co. Ltd.

www.cardindia.com

An absolute winner!



Improved Metallurgy. Greater Strength. Consistent Performance

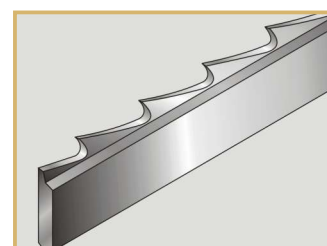
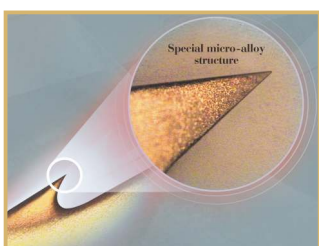

ProLyf Gold Cylinder Wires

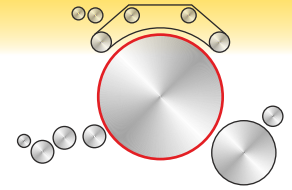

The ever increasing demand to improve the performance of cardclothing has led ICC to incorporate newer technologies in the manufacturing of cardclothing. Today's high production cards can work for more than 150 kg/hour. These cards need cardclothing, which has high precision where each tooth matches the specific parameters, has excellent surface finish and refined microstructure to increase resistance to wearing of the wire tip.

In continuation with our development of ProLyf series of cardclothing, we have now come up with a new range of alloy steel wires called ProLyf Gold. Apart from the special alloy composition, this series has tip designs to suit different fibres. The manufacturing process ensures consistency of each tooth throughout the length of the wire. An innovative heat treatment process used to manufacture the ProLyf Gold series produces a superlative surface finish. This ensures low friction between the fibre and the wire points, which is critical to high production cards. In addition to the refined micro structure on the wire tip, the ProLyf Gold range of wires process fibres on cards at high production rates to deliver consistent quality of the yarn.

Salient features:

- Wires made from special micro alloy steel to achieve longer life at high production rate.
- Superlative surface finish leading to generation of low heat and reduced fibre rupture even at high production rate.
- Ensures high consistency in performance of the cardclothing over longer period of time.
- Reduced running-in-period of the card.
- Introduction of the innovative heat treatment process, leading to refinement of the microstructure to achieve extended life of the cardclothing.
- Lower maintenance cost while maximising productivity.



| Type of wire | Height (mm) | Rib (mm) | Front Angle | PPSI |
|-----------------------|-------------|----------|-------------|------|
| M 64 17 20 57 PRO G | 2.0 | 0.4 | 57° | 1090 |
| M 64 15 20 55 PRO G | 2.0 | 0.4 | 55° | 950 |
| M 51 17 20 57 PRO G | 2.0 | 0.5 | 57° | 860 |
| M 42 17 20 57 PRO G | 2.0 | 0.6 | 57° | 720 |
| M 51 15 25 70 PRO G | 2.5 | 0.5 | 70° | 760 |
| M 42 17 25 65 PRO G | 2.5 | 0.6 | 65° | 720 |
| CMF 64 15 20 53 PRO G | 2.0 | 0.4 | 53° | 950 |
| CMF 51 17 20 57 PRO G | 2.0 | 0.5 | 57° | 860 |
| CMF 51 16 20 53 PRO G | 2.0 | 0.5 | 53° | 816 |
| CMF 51 15 20 53 PRO G | 2.0 | 0.5 | 53° | 760 |
| CMF 42 17 20 70 PRO G | 2.0 | 0.6 | 70° | 720 |
| CMF 42 17 20 53 PRO G | 2.0 | 0.6 | 53° | 720 |

Effective Date: 15 April 2022. This issue supersedes all earlier issues.

The Indian Card Clothing Co. Ltd.

CORPORATE & HEAD OFFICE: Plot No. 265, Sector -10, M.I.D.C. Bhosari, Pune - 411 026, INDIA.

Tel: +91 20 6132 6700(Operator), Direct: (20) 6132 6724 (Domestic), +91 20 6132 6725 (Export),

Email: sales@cardindia.com (Domestic), export@cardindia.com (Export), Website : www.cardindia.com

HIMACHAL PRADESH FACTORY: Manjholi, Nalagarh Ropar Road, Tehsil-Nalagarh (HP) -174 101. Tel: (1795) 393429/ 393432/

393400, Fax: (1795) 393440, Email: icchp@cardindia.com | **AHMEDABAD:** Tel (79) 32911656, Mob: 09327024068

Fax: (79) 652 41656 Email: iccahm@cardindia.com | **COIMBATORE:** Tel: (422) 256 1458/1459 & 4351458, Fax: (422) 256 2384,

Mob: 09345178828 Email: iccbe@cardindia.com | **LUDHIANA:** Tel: (161) 272 0898/323 7603. Fax: (161) 503 1147

Mob: 09316912628 Email: icldh@cardindia.com | **MADURAI:** Tel: (452) 266 8071/266 8330/3251676. Mob: 09344105864

Email: iccmdu@cardindia.com | **MUMBAI:** Mob: 09322593037, Email: iccbom@cardindia.com. | **PANIPAT:** Mob: 08956145187

Email: panipatbranchhead@cardindia.com | **TURKEY:** Tel: 0344 236 61 04-05. Fax: 0344 236 6103. Email: iccturkey@cardindia.com.